

**Slotted Binding Truss** **HEAD DIMENSIONS**

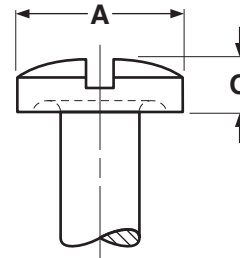

SLOTTED BINDING HEADS UNDERCUT FOR MACHINE SCREWS														ASME B18.6.3 2013				
Nominal Size	A		F				O		J		T		U				X	
	Head Diameter		Height of Head				Width of Slot		Depth of Slot		Dimensions of Undercut							
			Height of Oval		Total Height								Diameter		Depth			
	Max	Min	Max	Min	Max	Min	Max	Min	Max	Min	Max	Min	Max	Min	Max	Min		
2	.181	.171	.018	.013	.050	.043	.031	.023	.030	.020	.141	.124	.010	.005				
3	.208	.197	.022	.016	.059	.052	.035	.027	.036	.025	.162	.143	.011	.006				
4	.235	.223	.025	.018	.068	.061	.039	.031	.042	.030	.184	.161	.012	.007				
5	.263	.249	.029	.021	.078	.069	.043	.035	.048	.035	.205	.180	.014	.009				
6	.290	.275	.032	.024	.087	.078	.048	.039	.053	.040	.226	.199	.015	.010				
8	.344	.326	.039	.029	.105	.095	.054	.045	.065	.050	.269	.236	.017	.012				
10	.399	.378	.045	.034	.123	.112	.060	.050	.077	.060	.312	.274	.020	.015				
12	.454	.430	.052	.039	.141	.130	.067	.056	.089	.070	.354	.311	.023	.018				
1/4	.525	.498	.061	.046	.165	.152	.075	.064	.105	.084	.410	.360	.026	.021				

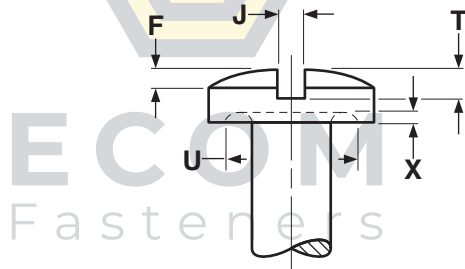
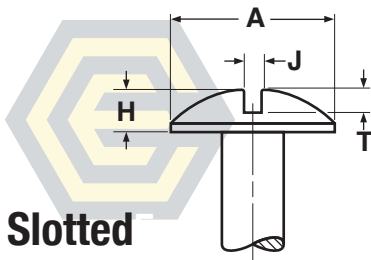

**Slotted**

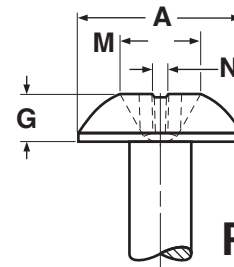

**Phillips**

TRUSS HEADS FOR MACHINE SCREWS													ASME B18.6.3-2013	
Nominal Size	A		H		J		T		M	G		Phillips Driver Size		
	Head Diameter		Height of Head		Width of Slot		Depth of Slot		Recess Diameter	Recess Penetration Gaging Depth				
	Max	Min	Max	Min	Max	Min	Max	Min	Ref	Max	Min			
2	.194	.180	.053	.044	.031	.023	.031	.022	.097	.052	.034	1		
3	.226	.211	.061	.051	.035	.027	.036	.026	.103	.059	.042	1		
4	.257	.241	.069	.059	.039	.031	.040	.030	.105	.062	.044	1		
5	.289	.272	.078	.066	.043	.035	.045	.034	.121	.078	.060	1		
6	.321	.303	.086	.074	.048	.039	.050	.037	.151	.073	.048	2		
8	.384	.364	.102	.088	.054	.045	.058	.045	.166	.088	.063	2		
10	.448	.425	.118	.103	.060	.050	.068	.053	.181	.104	.079	2		
12	.511	.487	.134	.118	.067	.056	.077	.061	.241	.111	.086	3		
1/4	.573	.546	.150	.133	.075	.064	.087	.070	.256	.126	.101	3		
5/16	.698	.666	.183	.162	.084	.072	.106	.085	.345	.173	.148	4		
3/8	.823	.787	.215	.191	.094	.081	.124	.100	.376	.206	.182	4		
1/2	1.073	1.028	.280	.250	.106	.091	.161	.131	.437	.268	.243	4		